

Installation Instructions / Warranty

hansgrohe

Single Control Lavatory Faucets



4" Centerset



Single Hole

interaktiv

hansgrohe

Interaktiv 4" Centerset Faucets

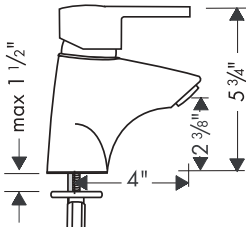

06873XX0
Interaktiv S

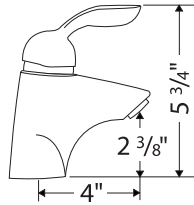

Solaris
06632XX0

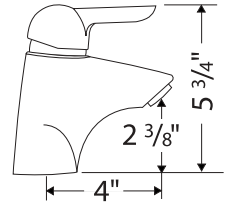

Stratos
06576XX0

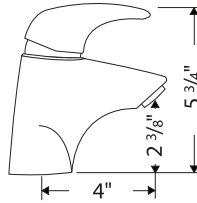

Monsoon
06915XX3

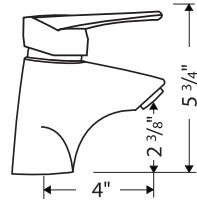

Metro
06552XX0

Product Specifications

Recommended incoming water pressure	22 - 72 PSI
Recommended incoming hot water temperature	120° - 140°F*
Maximum mounting surface thickness	1 1/2"
Flow rate	2.2 gpm max.

*some municipalities have codes limiting the maximum temperature of the water heater to 120°F or less. Please know and follow all applicable local codes when setting the temperature on the water heater.

Installer notes: Centerset Lavatory Faucet

- This faucet is intended for use on a lavatory or countertop that is pre-drilled for a 4" centerset faucet. It is not suitable for use in other installations.
- The flexible supply hoses require supply stops with 3/8" compression fittings - **not included**.
- This faucet ships from the factory with the high temperature limit stop pre-set to the maximum position. It may be reset if desired.

Install the Centerset Faucet

- Turn off the water at the supply stops – usually located under the sink. Turn on the faucet to confirm that the water is off. Remove existing faucet.
- Place your new Hansgrohe faucet with attached gasket on the mounting surface (sink top).
- Slide mounting washer over mounting bolt .
- Tighten mounting collar with flathead screwdriver to mounting bolt and mounting washer.
- Repeat with second mounting bolt.
- Secure the supply lines to the stops with the 3/8" compression fittings (not included).
- Turn on water supply. Check for leaks; check for leaks at the water supply connection.
- Install pop up drain.
- Re-set high temperature limit stop, if desired. Install handle.

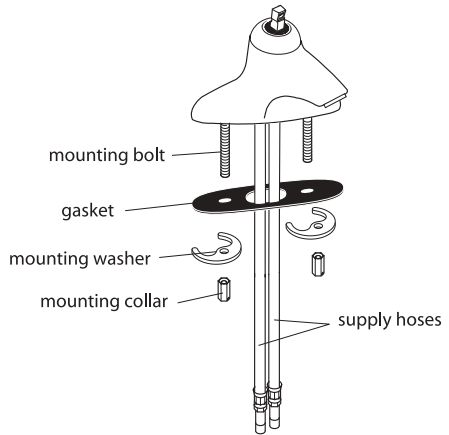

Replacement Parts

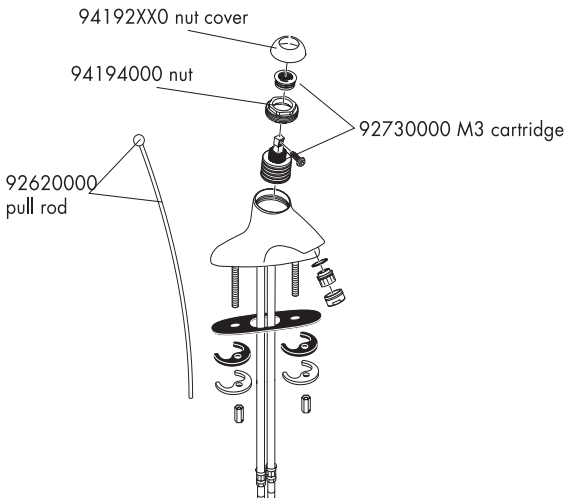

Single Hole Lavatory Faucets

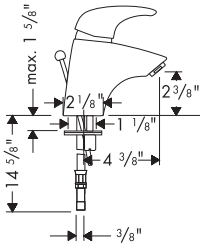

Monsoon
06922XX0

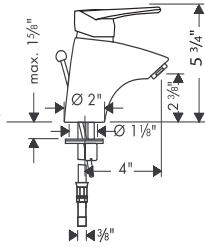

Metro
06571XX0

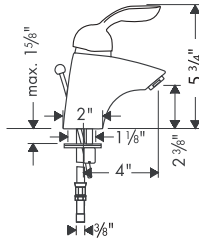

Solaris
06631XX0

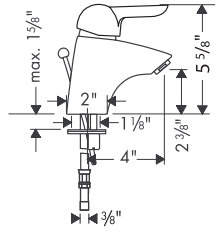

Stratos
06575XX0

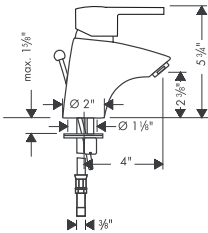

Interaktiv S
06872002

Product Specifications

Recommended incoming water pressure
 Recommended incoming hot water temperature
 Hole size in mounting surface
 Maximum mounting surface thickness
 Flow rate

22 - 72 PSI
 120° - 140°F*
 min 1 1/4"
 max 1 5/8"
 1 5/8"
 2.2 gpm max.

*some municipalities have codes limiting the maximum temperature of the water heater to 120°F or less. Please know and follow all applicable local codes when setting the temperature on the water heater.

Installation Considerations

- For best results, Hansgrohe recommends installation by a licensed professional plumber.
- Large differences in pressure between the hot and cold supplies should be balanced.
- The supply hoses on this faucet require supply stops with 3/8" compression fittings (not included).
- This faucet has a high temperature limit stop. It ships from the factory on the maximum setting, but may be reset to a lower temperature if desired.

Install the faucet

- Place the faucet and sealing ring on top of the mounting surface.
- From underneath, install the fixation piece over the threaded rod. Thread the nut onto the threaded rod until the fixation piece and gasket are firmly against the bottom of the mounting surface.
- Secure the supply lines to the stop valves with the 3/8" compression fittings (not included).
- Install the drain.
- Re-set the high temperature limit stop (if desired). Install the handle.
- Turn on the water and check for leaks at all connections.

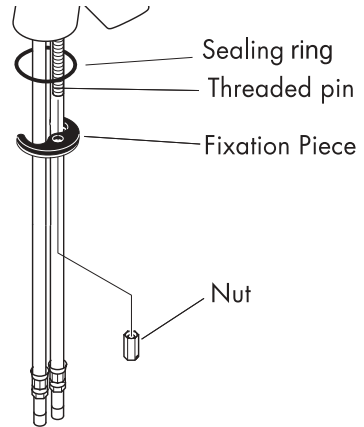

Replacement Parts

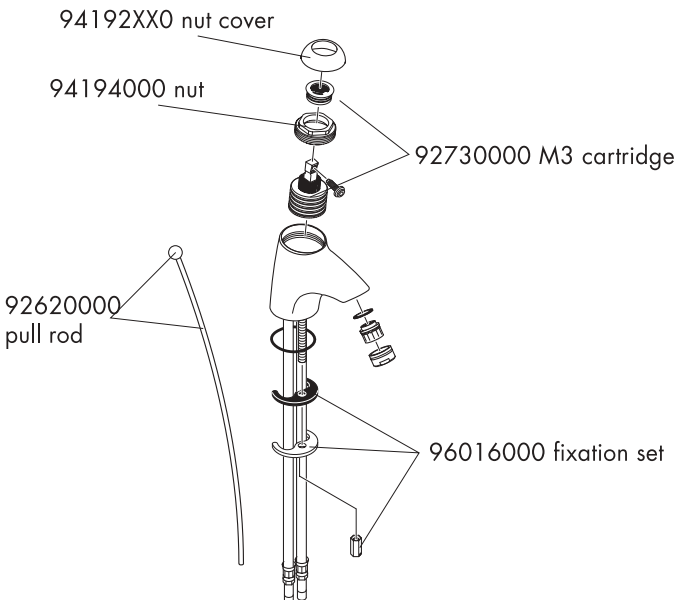

Set the High Temperature Limit Stop (optional)

- Remove the decorative flange.
- Remove the handle screw from the stem of the cartridge.

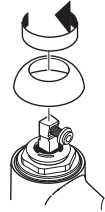

- Remove the high temperature limit stop.

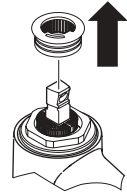

- Replace the high temperature limit stop so that the pin is in the desired notch. The temperatures marked on the diagram assume an incoming hot water temperature of 140° F and an incoming cold water temperature of 50° F, and a water pressure of 45 psi. Your high temperature will vary according to your conditions.

- Replace the nut cover.

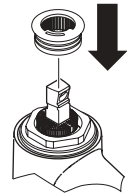
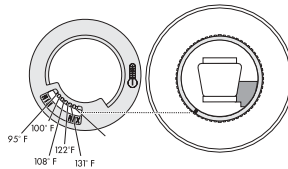

Install the handle

- If it was removed while re-setting the high temperature limit stop, thread the handle screw onto the M3 stem 4 complete turns.

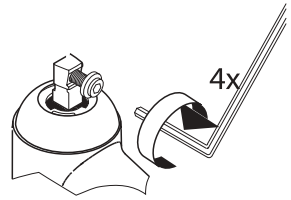

- Slide the handle over the stem and screw. Use the enclosed 4 mm hex wrench to finish tightening the screw. Turn the handle to one side to more easily access the screw.
- Install the screw cover.

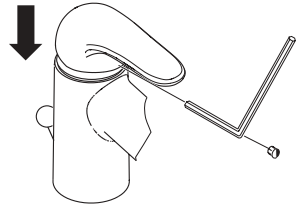

Install the Pop Up Drain

- Remove the plunger assembly.
- Unscrew the drain outlet flange from the tee.
- Unscrew the tailpiece from the tee. Wrap the threads with plumbers' thread tape and replace.
- Install the flexible sealing gasket to the flange. Sit it in the sink outlet.
- From under the sink, install the black mack gasket, white friction ring, and retainer nut to the flange. Do not tighten the nut against the bottom of the sink at this time.

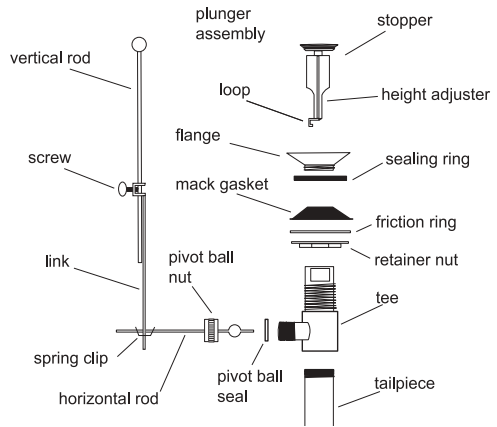

- Thread the tee and tailpiece to the flange. The pivot must face the faucet. If necessary, turn the drain assembly.
- Tighten the retainer nut.
- Sit the plunger assembly in the drain.
- Install the horizontal rod through the pivot ball gasket and into the tee so that the end goes through the loop in the bottom of the height adjuster.
- Slide link over end of vertical rod. Tighten screw.
- Slide one end of spring clip over end of horizontal rod. Slide link over end of horizontal rod. Test motion of drain plunger. Reposition link as necessary.
- When satisfied with the action of the drain, slide the other end of the spring clip over the end of the horizontal rod.

Cleaning Recommendation for Hansgrohe Products

Modern faucetry and shower products utilize a combination of materials to comply with the needs of the market with regard to design and functionality.

To avoid damage, it is necessary to use some caution when cleaning. Damage caused by improper treatment is not covered under the Hansgrohe warranty.

Cleaning Materials for Faucets and Showers

- To remove lime scale, use only products made specifically for that purpose. Always follow the manufacturer's instructions when using.
- Do not use cleaners that contain hydrochloric, formic, acetic, or phosphoric acids, as these will cause considerable damage to finishes and to plastic components.
- Never mix cleaning materials.
- Never use cleaners containing abrasives. Do not use abrasive cleaning cloths, pads, or sponges.

Cleaning Procedures

- Clean your faucets and shower products as and when required. Regular cleaning will prevent scale buildup and water spotting.
- Follow the label instructions. Do not allow any cleaner to remain on the product for longer than necessary.
- When using spray cleaners, spray first onto a sponge or cloth – do not spray directly onto the product.
- After cleaning, rinse thoroughly with clear water to remove any cleaner residue.

Important

- Soap and shampoo residue can also cause damage to the product. Rinse well with clean water after use.
- If the surface is already damaged, harsh cleaning materials will cause further damage.

Limited Lifetime Consumer Warranty

This product has been manufactured and tested to the highest quality standards by Hansgrohe, Inc. ("Hansgrohe"). This warranty is limited to Hansgrohe products which are purchased by a consumer in the United States after March 1, 1996, and installed in either the United States or Canada.

WHO IS COVERED BY THE WARRANTY

This warranty extends to the original consumer purchaser only.

WHAT IS COVERED BY THE WARRANTY

This warranty covers only your Hansgrohe manufactured product. Hansgrohe warrants this product against defects in material or workmanship as follows: Hansgrohe will repair at no charge for parts only or, at its option, replace any product or part of the product which proves defective because of improper workmanship and/or material, under normal installation, use, service and maintenance. If Hansgrohe is unable to provide a replacement and repair is not practical or cannot be timely made, Hansgrohe may elect to refund the purchase price in exchange for the return of the product.

LENGTH OF WARRANTY

Replacement or repaired parts of products will be covered for the term of this warranty as stated in the following two sentences. If you are a consumer who purchased the product for use primarily for personal, family, or household purposes, this warranty extends for as long as you own the product and the home in which the product is installed. If you purchased the product for use primarily for any other purpose, including, without limitation, a commercial purpose, this warranty extends only (i) for 1 year, with respect to Interaktiv and Retroaktiv products, and (ii) for 5 years, with respect to AXOR, ShowerPower and Pharo products.

THIS WARRANTY DOES NOT COVER, AND HANSGROHE WILL NOT PAY FOR:

- A. Conditions, malfunctions or damage not resulting from defects in material or workmanship.
- B. Conditions, malfunctions or damage resulting from (1) improper installation, improper maintenance, misuse, abuse, negligence, accident or alteration, or (2) the use of abrasive or caustic cleaning agents or "no rinse" cleaning products, or the use of the product in any manner contrary to the product instructions.
- C. Labor or other expenses for the disconnection or return of the product for warranty service, or for installation or reinstallation of the product.
- D. Accessories or related products not manufactured by Hansgrohe.

TO OBTAIN WARRANTY SERVICE

Contact your Hansgrohe retailer, or write to Technical Service at:

Hansgrohe Inc.
1492 Bluegrass Lakes Parkway
Alpharetta GA 30004

Or, call Hansgrohe toll-free at (800) 334-0455.

In requesting warranty service, you will need to provide

- 1. The sales receipt or other evidence of the date and place of purchase.
- 2. A description of the problem.
- 3. Delivery of the product or the defective part, postage prepaid and carefully packed and insured, to Hansgrohe Inc. 1492 Bluegrass Lakes Parkway, Alpharetta, Georgia 30004, Attention: Technical Service, if required by Hansgrohe.

When warranty service is completed, any repaired or replacement product or part will be returned to you postage prepaid.

EXCLUSIONS AND LIMITATIONS

REPAIR OR REPLACEMENT (OR, IN LIMITED CIRCUMSTANCES, REFUND OF THE PURCHASE PRICE) AS PROVIDED UNDER THIS WARRANTY IS THE EXCLUSIVE REMEDY OF THE PURCHASER. HANSGROHE NEITHER ASSUMES NOR AUTHORIZES ANY PERSON TO CREATE FOR IT ANY OBLIGATION OR LIABILITY IN CONNECTION WITH THIS PRODUCT.

HANSGROHE SHALL NOT BE LIABLE TO PURCHASER OR ANY PERSON FOR ANY INCIDENTAL, SPECIAL, OR CONSEQUENTIAL DAMAGES, ARISING OUT OF BREACH OF THIS WARRANTY OR ANY IMPLIED WARRANTY (INCLUDING MERCHANTABILITY).

Some States do not allow the exclusion or limitation of incidental or consequential damages, so the above limitation or exclusion may not apply to you.

This warranty gives you specific legal rights, and you may have other rights which vary from State to State.

You may be required by law to give us a reasonable opportunity to correct or cure any failure to comply before you can bring any action in court against us under the Magnuson-Moss Warranty Act.

PRODUCT INSTRUCTIONS AND QUESTIONS

Upon purchase or prior to installation, please carefully inspect your Hansgrohe product for any damage or visible defect. Prior to installing, always carefully study the enclosed instructions on the proper installation and the care and maintenance of the product. If you have questions at any time about the use, installation, or performance of your Hansgrohe product, or this warranty, please call or write to us at the toll-free number and address printed above.

