

# **SPEAKMAN COMPANY**

## **SE-927 Installation, Maintenance & Operation Instructions**

### **EYESAVER® LABORATORY DRENCH HOSE**

#### **DESCRIPTION**

Deck mounted or hand held laboratory drench hose supplied with twin aerated heads with flip-off dust covers, and self-closing valve, with automatic stay-open feature activated by squeeze handle.

#### **SPECIFICATIONS**

SPRAY HEAD: (2) Aerated, Yellow ABS Plastic Spray Outlet, and Dust Cover.  
VALVE: 3/8" NPT Female Brass, Chrome-Plated. Self-Closing with Automatic Stay-Open Feature.  
ACTIVATOR: Brass, Chrome-Plated Squeeze Handle.  
HOSE: 6' Reinforced, 750 PSI Burst Pressure.  
FLANGE: Brass, Chrome-Plated.  
INLET: 3/8" NPTM, Swivel Connection  
SHIPPING WEIGHT: 3.27 lbs.  
EMERGENCY SIGN: 7-7/8" x 7-7/8" Plastic Wall Sign.

#### **OPTIONS**

◇ SGN4 (Eye Wash Floor Sign)	◇ SSHSE (Stainless Steel Hose)
◇ VB (Dual Check Backflow Preventer)	◇ VB-CT (Vacuum Breaker)

#### **INSTALLATION**

This unit is completely assembled and tested before shipment. At desired location on countertop (that has a maximum thickness of 2-1/4") drill a 1-1/8 to 1-1/4" diameter hole. Mount unit in hole using supplied hardware. Connect a water supply to the unit (use pipe sealant on connection) that is an uninterrupted source of potable water. Failure to use potable water can result in emergency units producing impure or contaminated water causing possible further injury.

#### **OPERATION**

This drench hose is activated by squeezing the valve handle. Because of the automatic stay-open feature, the valve will open and remain on upon activation. An aerated flow of water will discharge from the twin outlets, and will continue to flow until the handle is squeezed, the stay-open plunger is pulled outward, and the handle is released.

#### **TESTING PROGRAM**

The American National Standards Institute (ANSI) states that all safety emergency equipment shall be activated on a weekly basis to flush the line and verify proper operation. Speakman Company furnishes a testing record tag (91-0635) with each unit. On this tag the date of inspection and the inspectors initials should be noted.

## MAINTENANCE

Should you need parts to repair this unit, please reference the parts list below for correct part numbers. Before any maintenance is done **be sure to shut the water supply off.**

**WARNING: Use only genuine Speakman parts when repairing or replacing components. To order parts call 1-800-537-2107.**

## SE-927 REPLACEMENT/REPAIR PARTS

<u>ITEM</u>	<u>PART/GROUP #</u>	<u>DESCRIPTION</u>
1	RPG38-0379	Spray Head Assy.
2	05-1177-PC	Aerator Assembly
3	G20-1742-PC-P	3/8" Valve w/ Auto Stay-Open
4	G63-0064	6' Hose Assy.
5	01-0239	1-1/16 -14 Locknut
6	24-0295-PC-P	Bull Horn Tee
7	26-0247-PC-P	Deck Flange
8	45-0593-CAD	Split Washer
9	48-0119-MO	10-24 x 3/8" Set Screw
10	31-0356-RCP-PUR	3/8"NPT CL Nipple

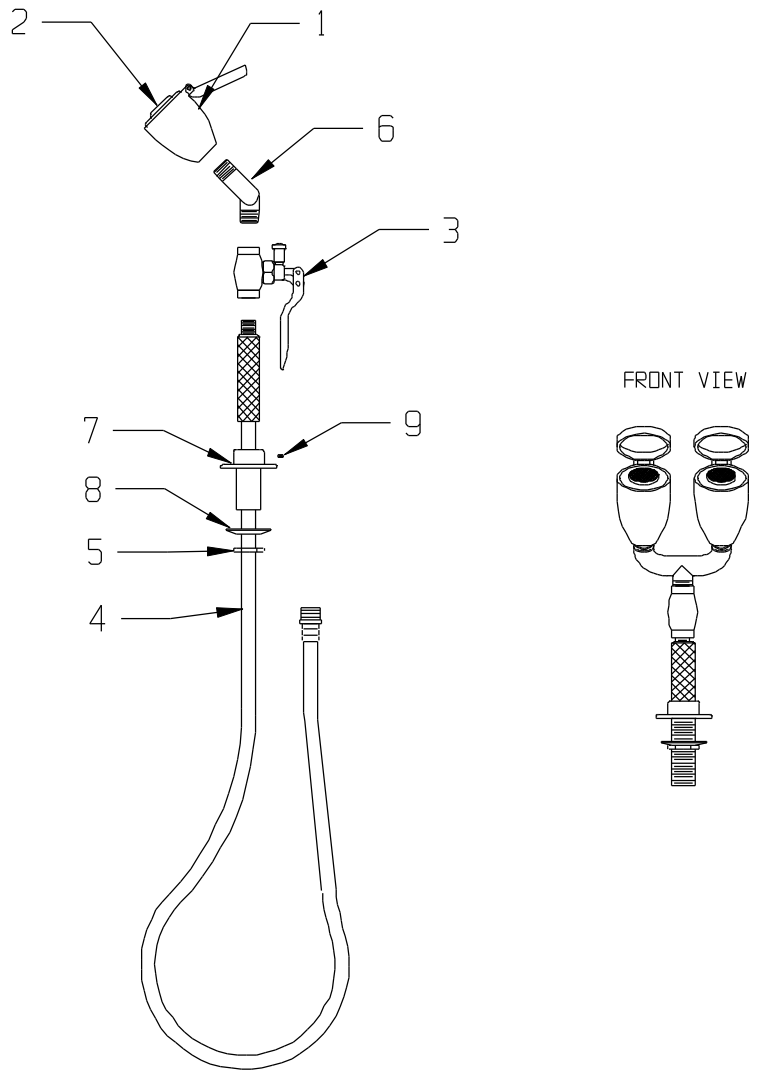

## FLOW DATA

DRENCH HOSE:

FLOW PRESSURE PSI (BAR)	30 (2.07)
FLOW RATE GPM (LPM)	2.37 (9)

NOTE: This unit should be connected to an uninterrupted source of potable water, with a minimum flowing pressure of 30 PSI and a maximum static pressure of 125 PSI.

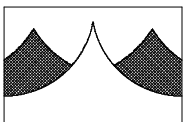

### **SPEAKMAN COMPANY**

The Quality leader Since 1869  
P.O. Box 191, Wilmington, DE 19899-0191 USA  
1-800-537-2107, Fax: 1-800-977-2747

Note: All units meet existing ANSI Z358.1 1998 Standards and OSHA Rules. Product improvements may cause specification and dimensional changes without notice.