

SPEAKMAN COMPANY

SE-340 Installation, Maintenance & Operation Instructions **LIFESAVER® MULTIPLE SPRAY SHOWER**

DESCRIPTION

Floor mounted multi-spray head decontamination station supplied with stay-open full flow ball valve; activated by stainless steel push handle; stainless steel panels, and spray heads with volume controls.

SPECIFICATIONS

SPRAY HEAD: (16) 1-1/2" Dia. Brass, Chrome-Plated.
VALVE: 1-1/2" NPT Female Brass.
ACTIVATOR: Stainless Steel Push Handle.
PIPE: 1" IPS Galvanized Steel.
INLET: 1-1/2" NPT Female.
SPRAY PANEL: (2) Stainless Steel.
FINISH: Painted Safety Green.
SHIPPING WEIGHT: 445 lb.
EMERGENCY SIGN: 7-7/8" x 7-7/8" Plastic Wall Sign.

OPTIONS

◇ AL1 (Air Horn Alarm)	◇ AL3-C1D2 (Electrical Alarm / Haz. Area)	◇ VPL (Vapor Proof Light)
◇ AL2 (Electrical Alarm)	◇ FLW (Flow Switch)	◇ SGN5 (Shower Floor Sign)
◇ AL3 (Electrical Alarm)	◇ FPV (Anti-Freeze Protection Valve)	◇
◇ AL2-C1D2 (Electrical Alarm / Haz. Area)	◇ SPV (Anti-Scald Protection Valve)	◇

INSTALLATION

This unit is shipped completely assembled. Place unit in desired location, and secure to floor using suitable anchors. Connect a water supply to the unit (use thread sealant on all joints) that is a 1-1/2" minimum uninterrupted source of potable water. Failure to use potable water can result in emergency units producing impure or contaminated water causing possible further injury. A drain or waste should be connected to an adequate drain in compliance with local plumbing codes.

OPERATION

Shower is activated by pushing the push handle back 90°. The unit will continue to discharge water until the push handle is manually pulled back up to the off position.

TESTING PROGRAM

The American National Standards Institute (ANSI) states that all safety emergency equipment shall be activated on a weekly basis to flush the line and verify proper operation. Speakman Company furnishes a testing record tag (91-0635) with each unit. On this tag the date of inspection and the inspectors initials should be noted.

MAINTENANCE

Should you need parts to repair this unit, please reference the parts listing below for correct part numbers. Before any maintenance is done **be sure to shut the water supply off.**

WARNING: Use only genuine Speakman parts when repairing or replacing components. To order parts call 1-800-537-2107.

SE-340 REPLACEMENT/REPAIR PARTS

<u>ITEM</u>	<u>PART/GROUP #</u>	<u>DESCRIPTION</u>
1	G04-0260-MO	Offset Push Handle
2	20-0895	1-1/2" Bronze Ball Valve
3	G38-0112-RCP	(16) 1-1/2" Dia.

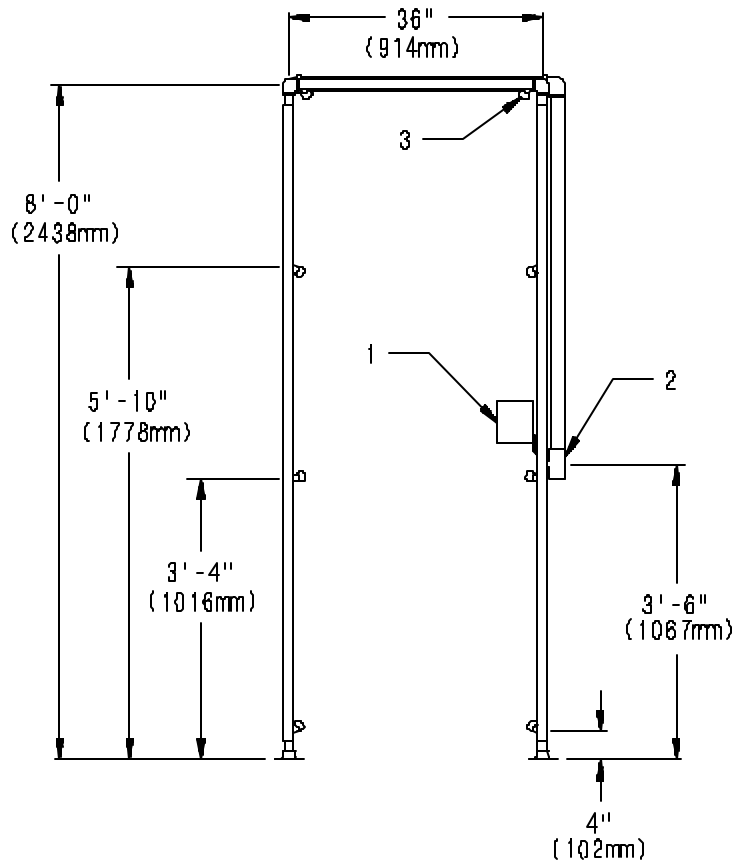

Spray Head

FLOW DATA

SHOWER:

FLOW PRESSURE PSI (BAR)	10 (.69)	15 (1.03)	20 (1.38)	25 (1.72)	50 (3.45)
FLOW RATE GPM (LPM)	57 (216)	74 (280)	88 (333)	97 (367)	134 (507)

NOTE: This unit should be connected to an uninterrupted source of potable water, with a minimum flowing pressure of 20 PSI and a maximum static pressure of 125 PSI.



Note: All units meet existing ANSI Z358.1 1998 Standards and OSHA Rules. Product improvements may cause specification and dimensional changes without notice.